



Road Management Services

Working on behalf of



0300 123 5000

www.nationalhighways.co.uk

19th September 2025

Major Maintenance on A419/A417

We are planning essential maintenance at the A419/A417. The work will affect various sections of the A419/A417. Please note that the remaining sections of the A419/A417 outside of the works area shall operate as usual.

What work is being carried out?

The work includes bridge painting and road marking replacement on various sections of the A419/A417.

What are the benefits to road users?

The bridge painting work is required to prolong the lifespan of the structure. This treatment will prevent water ingress into the bridge, which ensures the structure remain safe for use. Without this treatment, water ingress may cause significant damage which would require more disruptive repairs in future. Overall, both the bridge painting and road marking replacement will provide a safer and smoother journey for road users.

When and where will the work be carried out? (Traffic restrictions – check before you travel)

There are overnight closures scheduled on the A419/A417 network.

- **Overnight closure timings are from 20:00 hours until 06:00 hours the following morning**

Bridge Painting:

- **A419 Closure between Burford Road Interchange and Spine Road Junction (Diversion Route 6 Southbound)**
 - Overnight closures ONLY from Friday 19th September to Thursday 25th September

Road Marking Replacement:

- **A419 Closure between A420 White Hart Roundabout Junction and Commonhead Junction (Diversion Route 11 Southbound)**
 - Overnight closures ONLY from Monday 22nd September to Wednesday 24th September
- **A419 Closure between Commonhead Junction and M4 Junction 15 (Diversion Route 10 Southbound)**
 - Overnight closure ONLY on Thursday 25th September
- **A419 Closure between M4 Junction 15 and Commonhead Junction (Diversion Route 10 Northbound)**
 - Overnight closure ONLY on Friday 26th September
- **A419 Closure between Commonhead Junction and A420 White Hart Roundabout Junction (Diversion Route 11 Northbound)**
 - Overnight closures ONLY from Monday 29th September to Wednesday 1st October

The A419/A417 will be fully operational as usual outside of the specified hours. Diversion routes will be signed, and signage will also be in place before the start of works as a reminder.

Property access

Should access to your property be required, traffic management personnel will make every effort to facilitate this. However, some delay may occur while safety measures are implemented to allow safe passage through the work site. A contact number will be provided at the closure entrance for assistance.

Diversion route

The proposed diversion routes for the closures are outlined below. Please refrain from following satellite navigation systems and instead adhere to the signed diversion routes, which correspond to the diversion maps enclosed with this letter and are clearly marked

with diversion symbols at the start of the diversion routes (e.g. for Diversion Route 6 Southbound, follow ).

Diversion Route 6 Southbound – A419 Closure between Burford Road Interchange and Spine Road Junction

From the A417 Southbound Carriageway take the Burford Road Interchange exit slip and take the 4th exit at the roundabout over the A417 Carriageway signed Cirencester A429, Stroud (A419).

At 2nd roundabout take the 1st exit signed Cirencester A429, Stroud (A419).

At 3rd roundabout take 1st exit signed The South West, Stroud, Swindon A419, Chippenham (A429).

At 4th roundabout take the 1st exit signed Swindon A419.

At 5th roundabout take the 1st exit signed Swindon A419.

At 6th roundabout take 2nd exit signed (M4), Swindon A419.

At 7th roundabout, South Cerney Junction, take 1st exit and continue over the A419 Carriageway.

At 8th roundabout take 3rd exit onto A419 Southbound entry slip road.

Diversion Route 10 Northbound – A419 Closure between M4 Junction 15 and Commonhead Junction

From the A436 Northbound take 1st exit at M4 J15 roundabout onto M4 signed Bristol M4.

At M4 J16 exit slip roundabout take 4th exit onto Great Western Way signed Swindon A3102

At Blagrove roundabout take 2nd exit on to Great Western Way signed Town Centre A3102.

At Mannington roundabout take 2nd exit onto Great Western Way signed Great Western.

At The Meads roundabout take 2nd exit onto Great Western Way signed Barnfield B4006.

At Barnfield roundabout take 2nd exit onto Great Western Way signed Great Western.

At Bruce Street Bridges 1st roundabout take 1st exit signed Cheney Manor.

At Bruce Street Bridges 2nd roundabout take 2nd exit signed North Star B4289.

At Bruce Street Bridges 3rd roundabout take 1st exit onto Great Western Way signed Stratton B4289.

At North Star roundabout take 2nd exit onto Great Western Way signed Gorse Hill.

At Cackleberry 1st roundabout take 2nd exit signed Swindon Centre (M4 East).

At Cackleberry 2nd roundabout take 2nd exit onto Great Western Way signed Swindon Centre (M4 East).

At Transfer Bridges 1st roundabout take 3rd exit signed A4289.

At Transfer Bridges 2nd roundabout take 2nd exit onto Ocotal Way signed Swindon Centre.

At Colbourne roundabout take 1st exit onto Ocotal Way signed Through Traffic.

At Wills roundabout take 2nd exit onto Ocotal Way signed Oxford A420.

At junction turn right onto Drakes Way signed Motorway M4.

At Drakes roundabout take 1st exit onto Queens Drive signed Walcot E A4259.

At Coate roundabout take 3rd exit onto Marlborough Road signed Marlborough A4259.

At Commonhead roundabout take 1st exit signed A419.

Diversion Route 10 Southbound – A419 Closure between Commonhead Junction and M4 Junction 15

From the Commonhead Southbound exit slip take the 4th exit at the Commonhead roundabout onto Marlborough Road signed Swindon A4259.

At Coate roundabout take 3rd exit onto Queens Drive signed town centre A4259.

At Drakes roundabout take 2nd exit onto Drakes Way signed Burford (A361).

At junction turn left onto Ocotal Way signed Gorse Hill A4313.

At Wills roundabout take 2nd exit onto Ocotal way signed Cirencester (A419).

At Colbourne Roundabout take 3rd exit signed Gorse Hill.

At transfer bridges 1st roundabout take 3rd exit signed Gorse Hill (A419).

At transfer bridges 2nd roundabout take 1st exit onto Great Western Way signed North Star.

At Cocklebury 1st roundabout take 2nd exit signed West Swindon B4289.

At Cocklebury 2nd roundabout take 2nd exit onto Great Western Way signed Oasis.

At North Star roundabout take 2nd exit onto Great Western Way signed Great Western (M4 West).

At the Bruce Street Bridges 3rd roundabout take 2nd exit onto Great Western Way signed West Swindon B4006.

At Barnfield roundabout take 2nd exit onto Great Western Way signed Toothill (M4).

At The Meads roundabout take 2nd exit onto Great Western Way signed Town Centre B4006.

At Mannington roundabout take 2nd exit onto Great Western Way signed Wootton Bassett A3102.

At Blagrove roundabout take 2nd exit onto Great Western Way signed Wootton Bassett A3102.

At Spittleborough M4 Junction 16 roundabout take 1st exit onto the M4 signed London M4.

Diversion Route 11 Northbound – A419 Closure between Commonhead Junction and A420 White Hart Roundabout Junction

From the Commonhead northbound exit slip take the 1st exit at the Commonhead roundabout signed Swindon A4259.

At Coate Roundabout take 3rd exit onto Queens Drive signed town centre A4259.

At Drakes roundabout take 2nd exit onto Drakes Way Signed Burford (A361).

At Greenbridge roundabout take 3rd exit onto Slade Drive signed Oxford (A420).

At White Hart roundabout 5th exit signed Cirencester (A419N).

At island 1st exit onto slip signed Cirencester A419.

Diversion Route 11 Southbound – A419 Closure between A420 White Hart Roundabout Junction and Commonhead Junction

From the White Hart Southbound Exit Slip roundabout take the 4th exit onto Oxford Road signed Town Centre A4312.

At Greenbridge roundabout take the 2nd exit onto Drakes Way signed Town Centre A4312.

At Drakes roundabout take 1st exit onto Queens Drive signed Walcot E A4259.

At Coate roundabout take 3rd exit onto Marlborough Road signed Marlborough A4259.

At Commonhead roundabout take 4th exit signed Motorway M4.

Contact

Fatima Alawad (Stakeholder Support Manager)

Email: Fatima.Alawad@wsp.com

Yours sincerely,



Mike Jackson
Road Manager

Enc. Diversion Route Map

ROUTE 6

A417 Southbound Closed
Between
Burford Road Interchange
And
Spine Road Junction



CLOSED BETWEEN CIRENCESTER (BURFORD ROAD) AND SPINE ROAD JUNCTION.

Diversion Route
Symbol



Action Points

Step 1: Close A417/A419 Southbound carriageway at Burford Road Interchange.
Step 2: Open trigger signs at Burford Road Interchange Exit Slip Road.
Reverse procedure at end of closure.

A417 Southbound Main Carriageway at Burford Road Interchange Southbound Exit Slip Road.

Standard Road Closure to TMC requirements

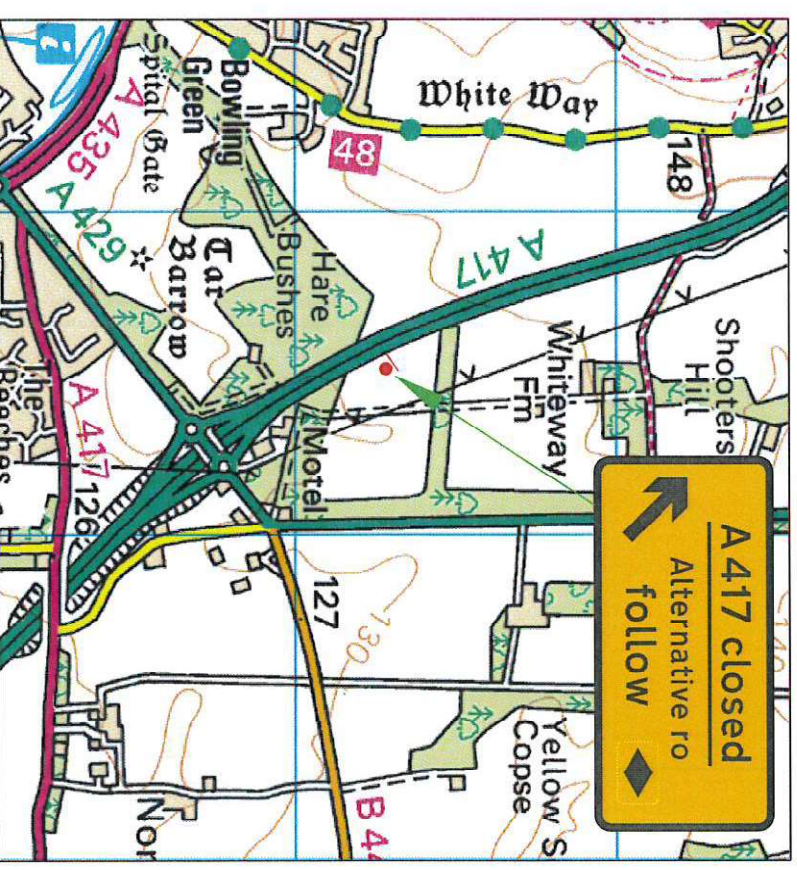
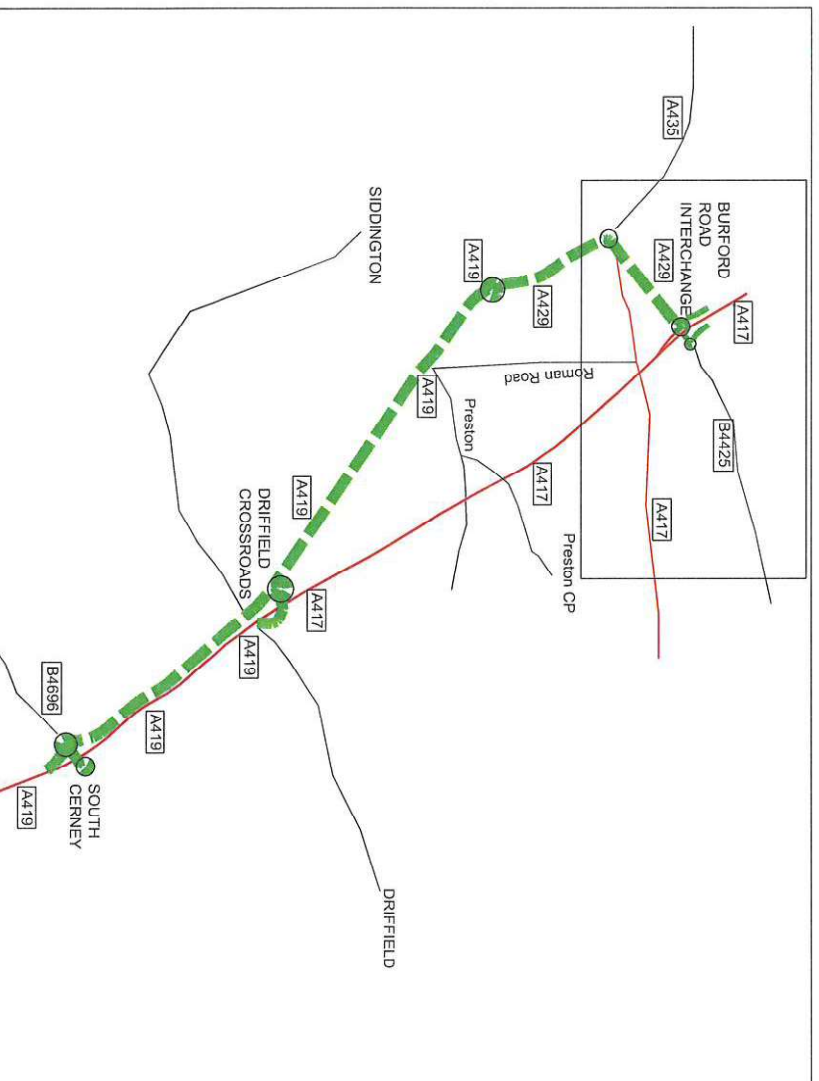

This route was agreed as the preferred option by the following parties during 2007:
Highways Agency, R.M.S. Gloucestershire Police and Gloucester County Council

HA HIGHWAYS
AGENCY

mouchel

Diversion Route 6 (Southbound)
Oct 2008

ROUTE 10

A419 Northbound Closed
Between
M4 Junction 15 Roundabout
And
Commonhead Roundabout



Diversion Route 10 - Northbound

A419 Closure between M4 Junction 15 and Commonhead Junction

Key:

Diversion Route 

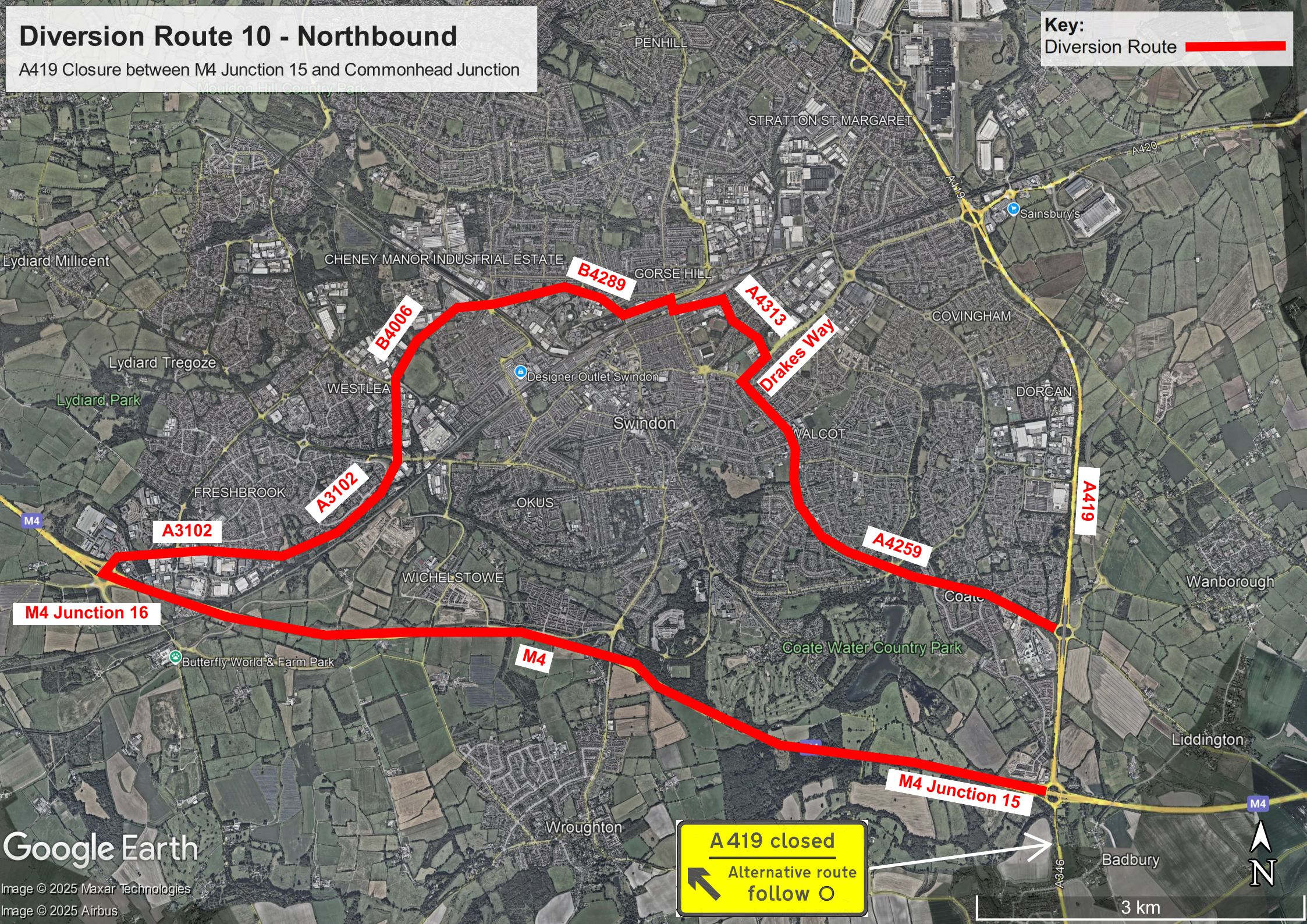

A3102

A3102

B4006

B4289

A4313

Drakes Way

A4259

A419

M4 Junction 16

M4

M4 Junction 15

A 419 closed

Alternative route follow O

Google Earth

Image © 2025 Maxar Technologies
Image © 2025 Airbus

3 km



ROUTE 10

A419 Southbound Closed

At

Commonhead Junction

And

M4 Junction 15



Diversion Route 10 - Southbound

A419 Closure between Commonhead Junction and M4 Junction 15

Key:

Diversion Route 

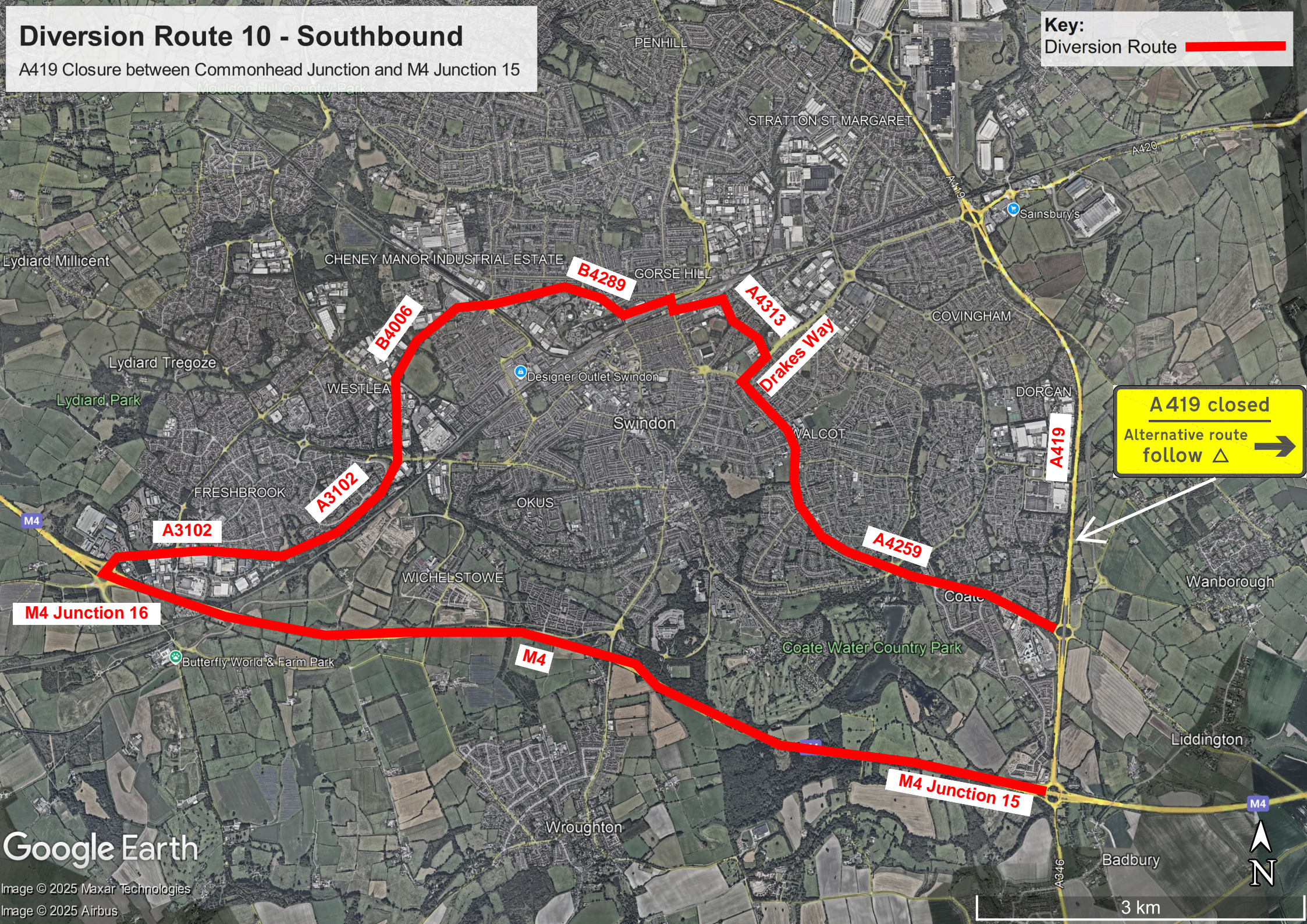

A 419 closed
Alternative route
follow Δ →

Google Earth

Image © 2025 Maxar Technologies
Image © 2025 Airbus

ROUTE 11

**A419 Northbound Closed
Between
Commonhead Roundabout
And
White Hart Roundabout**



A419 NORTHBOUND

CLOSED BETWEEN COMMONHEAD ROUNDABOUT AND WHITE HART ROUNDABOUT.



Diversion Route
Symbol

Action Points

- Step 1: Close A419 at Northbound carriageway at Commonhead roundabout junction with A4259.
- Step 2: Open trigger signs at Commonhead roundabout Northbound Exit Slip Road.
- Reverse procedure at end of closure.

A419 Northbound Carriageway at Commonhead Roundabout.

Standard Road Closure to TMC requirements

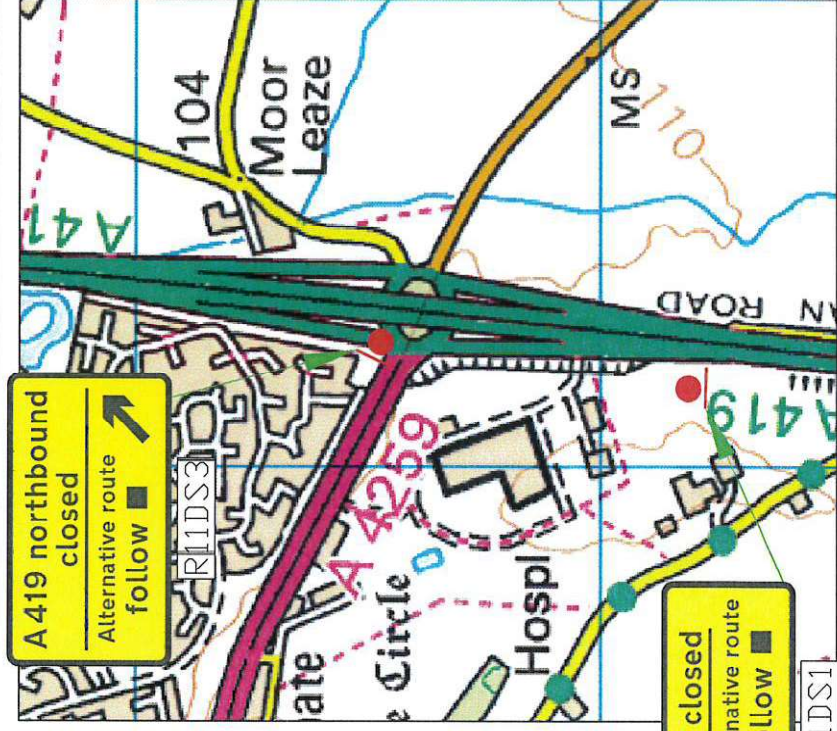
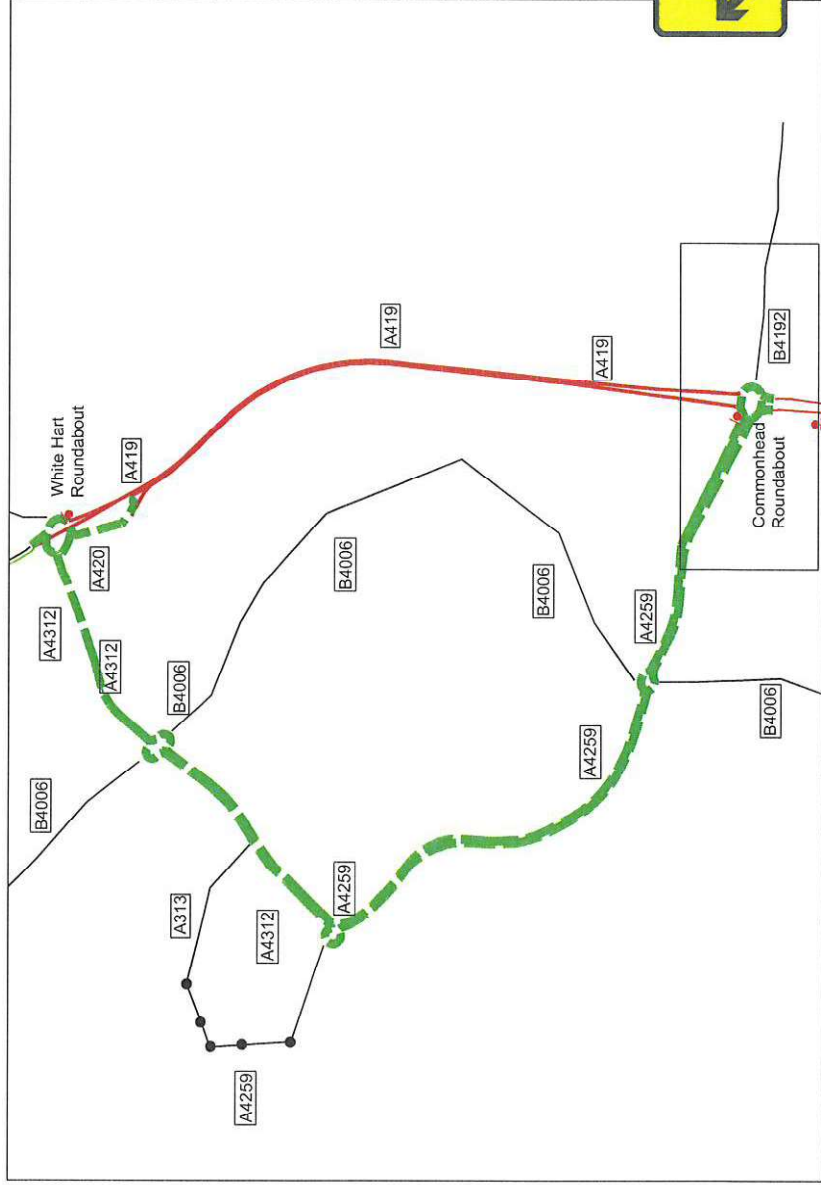

This route was agreed as the preferred option by the following parties during 2007:
Highways Agency, R.M.S. Gloucestershire Police and Gloucester County Council

HA HIGHWAYS
AGENCY

mouchel

Version
A
Diversion Route 11 (Northbound)
Date
Oct 2008

ROUTE 11

**A419 Southbound Closed
Between
White Hart Roundabout
And
Commonhead Roundabout**



A419 SOUTHBOUND CLOSED BETWEEN WHITE HART ROUNDABOUT AND COMMONHEAD ROUNDABOUT.



Diversion Route

Symbol

Action Points

Step 1: Close A419 at Southbound carriageway at White Hart roundabout junction with A419/A4312.

Step 2: Open trigger signs at White Hart roundabout Southbound Exit Slip Road

Reverse procedure at end of closure.

A419 Southbound Carriageway at White Hart Roundabout.

Standard Road Closure to TMC requirements

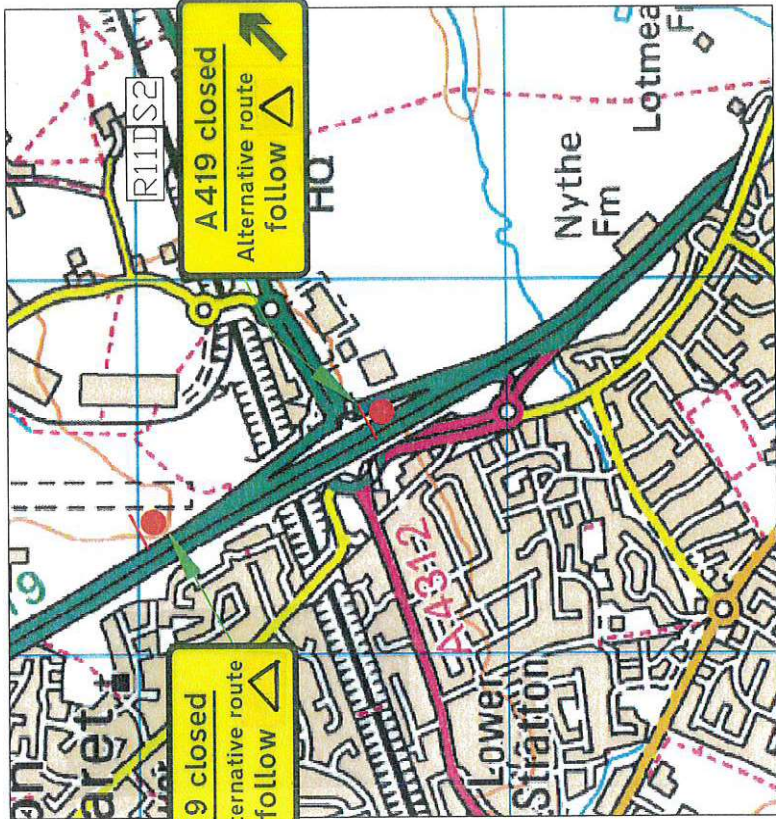
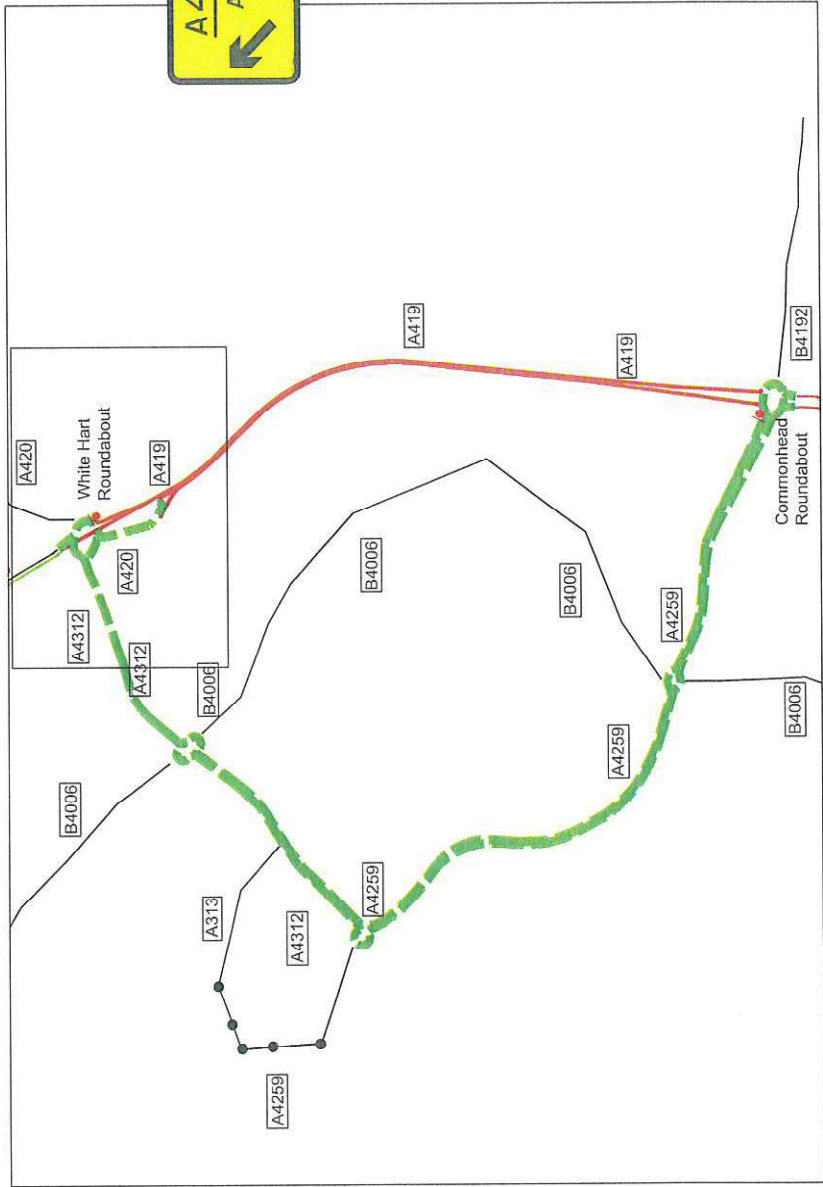

This route was agreed as the preferred option by the following parties during 2007:
Highways Agency, R.M.S. Gloucestershire Police and Gloucester County Council