



Road Management Services

Working on behalf of



0300 123 5000

www.nationalhighways.co.uk

28th July 2025

Major Maintenance on A419/A417

We are planning essential maintenance at the A419/A417. The work will affect various sections of the A419/A417. Please note that the remaining sections of the A419/A417 outside of the works area shall operate as usual.

What work is being carried out?

The works being delivered include essential resurfacing of the carriageway, concrete carriageway maintenance and road marking replacement on various sections of the A419/A417.

What are the benefits to road users?

Our work reduces interventions, so the road remains open thus reducing delays and improving journey time reliability. Also, it will provide a safer and smoother journey for road users.

When and where will the work be carried out? (Traffic restrictions – check before you travel)

There are night closures and a full weekend closure scheduled on the A419/A417 network.

- **Full weekend closure** from 20:00 hours on Friday to 06:00 hours on Monday
- **Overnight closure** from 20:00 hours until 06:00 hours the following morning

Resurfacing Works:

- **A419 Closure between Turnpike Junction and Spine Road Junction (Diversion Route 14 Northbound)**
 - Overnight closures ONLY from Friday 1st August to Monday 4th August (*excluding Sunday 3rd August*)

- **A419 Closure between Spine Road Junction and Burford Road Interchange (Diversion Route 6 Northbound)**
 - Overnight closure ONLY on Tuesday 5th August
- **A417 Closure between Quarry Interchange and Burford Road Interchange (Diversion Route 5 Southbound)**
 - Overnight closures ONLY on Wednesday 6th August and Thursday 7th August
- **A417 Closure between Burford Road and Quarry Interchange (Diversion Route 5 Northbound)**
 - Overnight closure ONLY on Friday 8th August

Concrete Carriageway Maintenance:

- **A417/A419 Closure between Quarry Interchange and Spine Road Junction (Combined Diversion Routes 5 and 6 Southbound)**
 - Full weekend closure from Friday 8th August at 20:00 hours to Monday 11th August at 06:00 hours

Road Marking Replacement – PLEASE NOTE THE DATES BELOW ARE SUBJECT TO CHANGE

- **A419 Closure between M4 Junction 15 and Commonhead Junction (Diversion Route 10 Northbound and Southbound)**
 - Overnight closures ONLY from Monday 11th August to Friday 15th August
- **A419 Closure between Commonhead Junction and A420 White Hart Roundabout Junction (Diversion Route 11 Northbound and Southbound)**
 - Weekdays Overnight closures ONLY from Monday 18th August to Friday 21st August

The A419/A417 will be fully operational as usual outside of the specified hours. Diversion routes will be signed, and signage will also be in place before the start of works as a reminder.

Property access

Should access to your property be required, traffic management personnel will make every effort to facilitate this. However, some delay may occur while safety measures are implemented to allow safe passage through the work site. A contact number will be provided at the closure entrance for assistance.

Diversion route

The proposed diversion routes for the closures are outlined below. Please refrain from following satellite navigation systems and instead adhere to the signed diversion routes, which correspond to the diversion maps enclosed with this letter and are clearly marked with diversion symbols at the start of the diversion routes (e.g. for Diversion Route 6 Northbound, follow ).

Diversion Route 5 Northbound – A417 Closure between Burford Road and Quarry Interchange

From the A417 Northbound Carriageway take the Burford Road Interchange exit slip road and take the 1st exit at the roundabout signed Cirencester A429, Stroud A419, Stratton.

At the next roundabout take 3rd exit signed Gloucester A417, Cheltenham (A435).

Continue on the A435 to split then straight on signed Daglingworth / Birdlip (Follow old A417 NOT A435) to the roundabout at the A417 Quarry Interchange.

Take the 2nd exit signed M5, Gloucester A417.

Diversion Route 5 Southbound – A417 Closure between Quarry Interchange and Burford Road Interchange

From the A417 Southbound Carriageway take the Quarry Interchange exit slip road and then take the 3rd exit at the roundabout signed Stratton.

Continue under A417 to the 2nd roundabout and take the 1st exit signed Stratton.

At Cirencester roundabout take the 1st exit signed Stow A429, Burford (B4425), Lechlade (A417).

At Burford Road Interchange roundabout take the 2nd exit over the A417 signed M4, Swindon A419.

At the next roundabout take the 3rd exit signed M4, Swindon A419.

Combined Diversion Routes 5 & 6 Southbound – A417/A419 Closure between Quarry Interchange and Spine Road Junction

From the A417 Southbound Carriageway take the Quarry Interchange exit slip road and then take the 3rd exit at the roundabout signed Stratton.

Continue under A417 to the 2nd roundabout and take the 1st exit signed Stratton.

At Cirencester roundabout take the 2nd exit signed The South West, Stroud, Swindon A419, Chippenham (A429).

At 4th roundabout take the 1st exit signed Swindon A419.

At 5th roundabout take the 1st exit signed Swindon A419.

At 6th roundabout take 2nd exit signed (M4), Swindon A419.

At 7th roundabout, South Cerney Junction, take 1st exit and continue over the A419 Carriageway.

At 8th roundabout take 3rd exit onto A419 Southbound entry slip road.

Diversion Route 6 Northbound – A419 Closure between Spine Road Junction and Burford Road Interchange

From the A419 Northbound Carriageway take the Spine Road Junction exit slip road and then take the 2nd exit at the roundabout signed Cirencester, Stroud A419.

At 2nd roundabout take the 1st exit continuing on the A419 Northbound.

At 3rd roundabout take the 2nd exit signed Cirencester A419.

At 4th roundabout take the 3rd exit Cirencester A419, Cheltenham (A435), Motorway (M5), Gloucester (A417), Stow (A429).

At 5th roundabout take the 3rd exit signed Stow A429, Burford (B4425), Lechlade (A417).

At 6th roundabout take the 1st exit signed (M5), Gloucester A417 onto entry slip road to A417 Northbound Carriageway.

Diversion Route 10 Northbound – A419 Closure between M4 Junction 15 and Commonhead Junction

From the A436 Northbound take 1st exit at M4 J15 roundabout onto M4 signed Bristol M4.

At M4 J16 exit slip roundabout take 4th exit onto Great Western Way signed Swindon A3102

At Blagrove roundabout take 2nd exit on to Great Western Way signed Town Centre A3102.

At Mannington roundabout take 2nd exit onto Great Western Way signed Great Western.

At The Meads roundabout take 2nd exit onto Great Western Way signed Barnfield B4006.

At Barnfield roundabout take 2nd exit onto Great Western Way signed Great Western.

At Bruce Street Bridges 1st roundabout take 1st exit signed Cheney Manor.

At Bruce Street Bridges 2nd roundabout take 2nd exit signed North Star B4289.

At Bruce Street Bridges 3rd roundabout take 1st exit onto Great Western Way signed Stratton B4289.

At North Star roundabout take 2nd exit onto Great Western Way signed Gorse Hill.

At Cockleberry 1st roundabout take 2nd exit signed Swindon Centre (M4 East).

At Cockleberry 2nd roundabout take 2nd exit onto Great Western Way signed Swindon Centre (M4 East).

At Transfer Bridges 1st roundabout take 3rd exit signed A4289.

At Transfer Bridges 2nd roundabout take 2nd exit onto Ocotal Way signed Swindon Centre.

At Colbourne roundabout take 1st exit onto Ocotal Way signed Through Traffic.

At Wills roundabout take 2nd exit onto Ocotal Way signed Oxford A420.

At junction turn right onto Drakes Way signed Motorway M4.

At Drakes roundabout take 1st exit onto Queens Drive signed Walcot E A4259.

At Coate roundabout take 3rd exit onto Marlborough Road signed Marlborough A4259.

At Commonhead roundabout take 1st exit signed A419.

Diversion Route 10 Southbound – A419 Closure between Commonhead Junction and M4 Junction 15

From the Commonhead Southbound exit slip take the 4th exit at the Commonhead roundabout onto Marlborough Road signed Swindon A4259.

At Coate roundabout take 3rd exit onto Queens Drive signed town centre A4259.

At Drakes roundabout take 2nd exit onto Drakes Way signed Burford (A361).

At junction turn left onto Ocotal Way signed Gorse Hill A4313.

At Wills roundabout take 2nd exit onto Ocotal way signed Cirencester (A419).

At Colbourne Roundabout take 3rd exit signed Gorse Hill.

At transfer bridges 1st roundabout take 3rd exit signed Gorse Hill (A419).

At transfer bridges 2nd roundabout take 1st exit onto Great Western Way signed North Star.

At Cocklebury 1st roundabout take 2nd exit signed West Swindon B4289.

At Cocklebury 2nd roundabout take 2nd exit onto Great Western Way signed Oasis.

At North Star roundabout take 2nd exit onto Great Western Way signed Great Western (M4 West).

At the Bruce Street Bridges 3rd roundabout take 2nd exit onto Great Western Way signed West Swindon B4006.

At Barnfield roundabout take 2nd exit onto Great Western Way signed Toothill (M4).

At The Meadows roundabout take 2nd exit onto Great Western Way signed Town Centre B4006.

At Mannington roundabout take 2nd exit onto Great Western Way signed Wootton Bassett A3102.

At Blagrove roundabout take 2nd exit onto Great Western Way signed Wootton Bassett A3102.

At Spittleborough M4 Junction 16 roundabout take 1st exit onto the M4 signed London M4.

Diversion Route 11 Northbound – A419 Closure between Commonhead Junction and A420 White Hart Roundabout Junction

From the Commonhead northbound exit slip take the 1st exit at the Commonhead roundabout signed Swindon A4259.

At Coate Roundabout take 3rd exit onto Queens Drive signed town centre A4259.

At Drakes roundabout take 2nd exit onto Drakes Way Signed Burford (A361).

At Greenbridge roundabout take 3rd exit onto Slade Drive signed Oxford (A420).

At White Hart roundabout 5th exit signed Cirencester (A419N).

At island 1st exit onto slip signed Cirencester A419.

Diversion Route 11 Southbound – A419 Closure between A420 White Hart Roundabout Junction and Commonhead Junction

From the White Hart Southbound Exit Slip roundabout take the 4th exit onto Oxford Road signed Town Centre A4312.

At Greenbridge roundabout take the 2nd exit onto Drakes Way signed Town Centre A4312.

At Drakes roundabout take 1st exit onto Queens Drive signed Walcot E A4259.

At Coate roundabout take 3rd exit onto Marlborough Road signed Marlborough A4259.

At Commonhead roundabout take 4th exit signed Motorway M4.

Diversion Route 14 Northbound – A419 Closure between Turnpike Junction and Spine Road Junction

From the Turnpike Northbound Exit Slip merge to the left, signed Swindon N&W A4311.

At 1st set of Traffic Lights continue onto Cricklade Road A4311, stay right.

At 2nd set of Traffic Lights continue straight onto Thamesdown Drive A4311, signed West Swindon.

At 3rd set of Traffic Lights continue straight on.

At 4th set of Traffic Lights continue straight on.

At 5th set of Traffic Lights continue straight on.

At 6th set of Traffic Lights continue straight on.

At 7th set of Traffic Lights continue straight on.

At 8th set of Traffic Lights continue straight on.

At 9th set of Traffic Lights continue straight on.

At 10th set of Traffic Lights continue straight on.

At Sparcells roundabout, take 2nd exit, signed M4, Hillmead, B4534.

At next roundabout take 2nd exit, signed M4, Hillmead, B4534.

At next roundabout take 1st exit, signed M4, Hillmead, B4534.

At next roundabout take 2nd exit signed M4, Shaw, B4534.

At next roundabout take 2nd exit to continue on B4534.

At next roundabout take 2nd exit signed M4, Town Centre, Westmead, Westlea, B4006.

At next roundabout take 3rd exit signed M4, Town Centre, Toothill, B4006.

At next roundabout take 2nd exit signed M4, Royal W. Bassett, Windmill, Blagrove, A3102.

At next roundabout take 2nd exit signed M4, Royal W. Bassett, A3102.

At next roundabout take 2nd exit signed M4 West.

At next roundabout take 2nd exit to continue on A3102.

At next roundabout take 2nd exit signed Malmesbury, Brinkworth, Cricklade, Ashton Keynes B4042.

Continue to Royal Wootton Bassett using the B4042 and travel to Ashton Keynes using the B4696.

Continue along B4696 onto entry slip road to A419 Northbound Carriageway.

Contact

Fatima Alawad (Stakeholder Support Manager)

Email: Fatima.Alawad@wsp.com

Yours sincerely,

M Byrne

Martin Byrne

Senior Highways Technician

Enc. Diversion Route Map

ROUTE 5

**A417 Northbound Closed
Between
Burford Road Interchange
And
Quarry Interchange**



A417 NORTHBOUND CLOSED BETWEEN BURFORD ROAD INTERCHANGE AND QUARRY INTERCHANGE

Diversion Route
Symbol



Action Points

Step 1: Close A417 Northbound carriageway at Burford road Interchange.
Step 2: Open trigger signs at Burford road Interchange Exit Slip road..
Reverse procedure at end of closure.

A417 Northbound Main Carriageway at Burford Road Northbound Exit Slip Road.

Standard Road Closure to TMC requirements

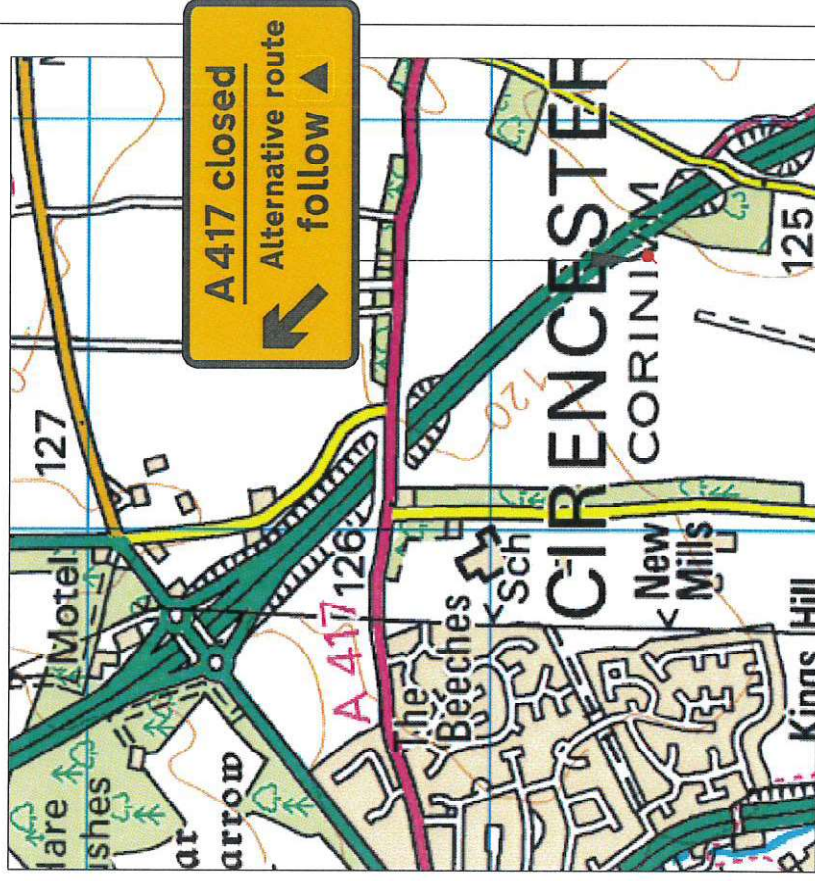
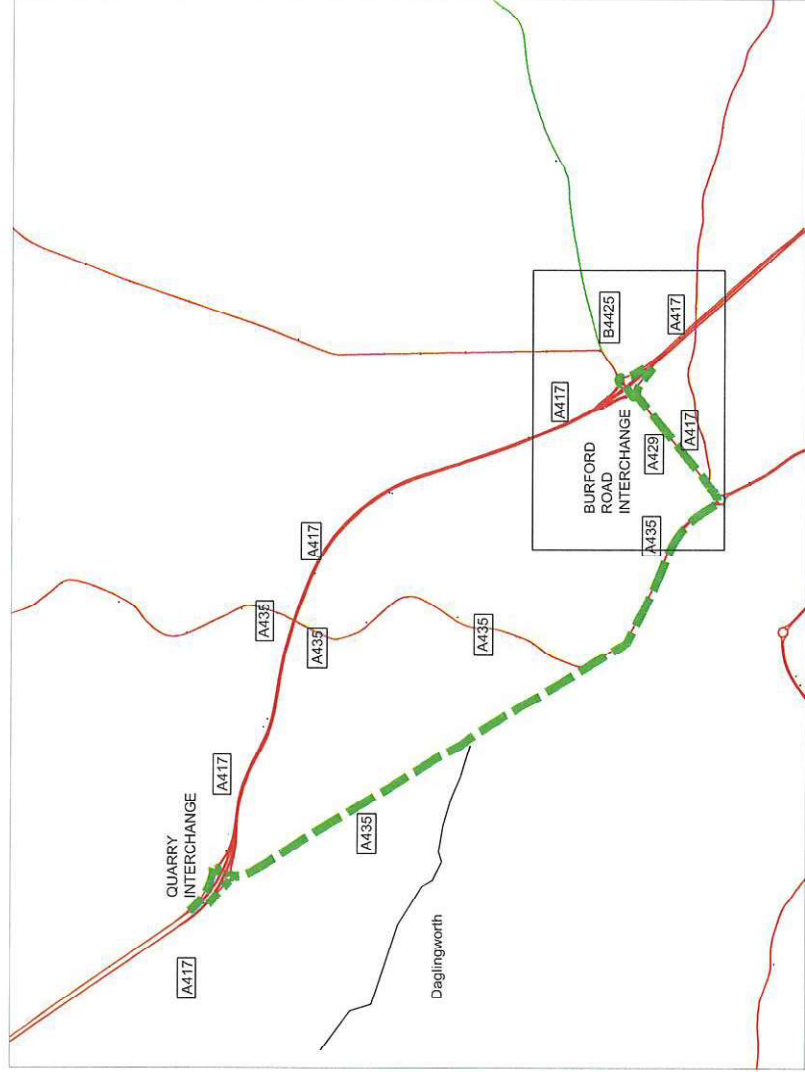

This route was agreed as the preferred option by the following parties during 2007:

Highways Agency, R.M.S. Gloucestershire Police and Gloucester County Council

HA HIGHWAYS
AGENCY

mouchel

Diversion Route 5 (Northbound)
Sept 2008

ROUTE 5

**A417 Southbound Closed
Between
Quarry Interchange
And
Burford Road Interchange**



A417 SOUTHBOUND

CLOSED BETWEEN QUARRY INTERCHANGE AND BURFORD ROAD INTERCHANGE

Diversion Route
Symbol



Action Points
 Step 1: Close A417 Southbound carriageway at Quarry Interchange.
 Step 2: Open trigger signs at Quarry Interchange Exit Slip Reverse procedure at end of closure.

A417 Southbound Main Carriageway at Quarry Interchange Southbound Exit Slip Road.
 Standard Road Closure to TMC requirements

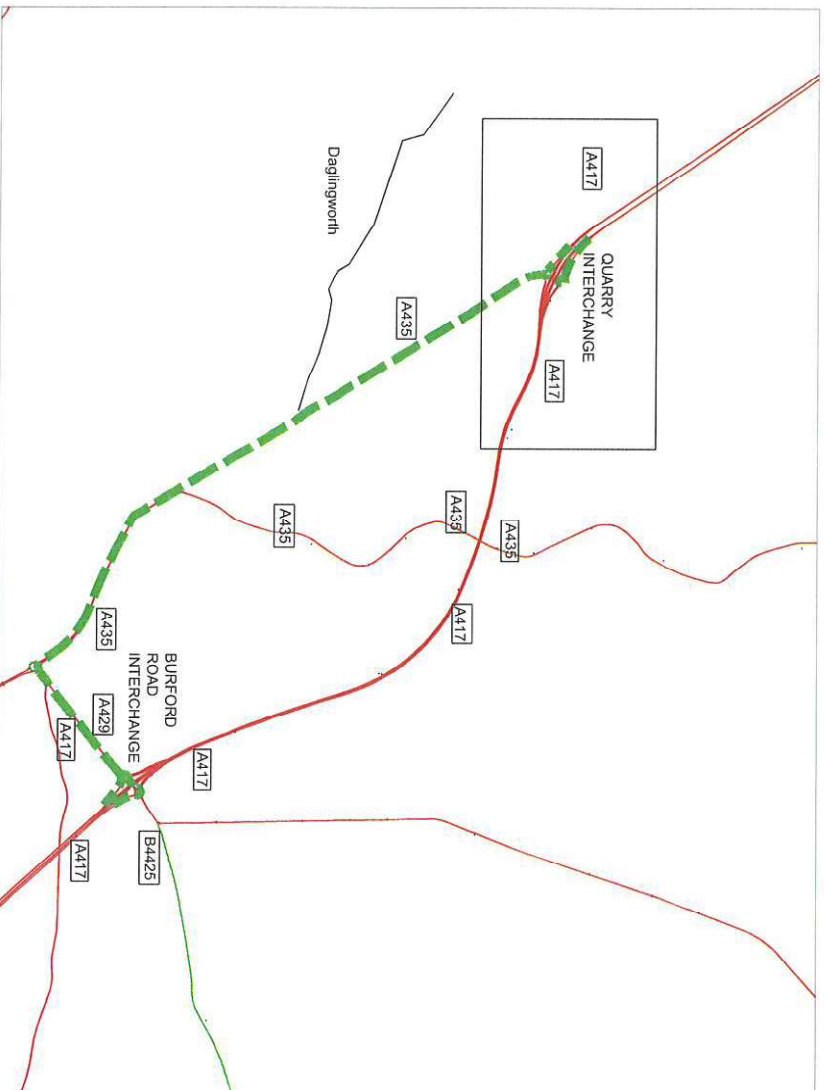

This route was agreed as the preferred option by the following parties during 2007:
 Highways Agency, R.M.S. Gloucestershire Police and Gloucester County Council

HA HIGHWAYS
 AGENCY

mouchel

Diversion Route 5 (Southbound)
 Sep 2008

A

ROUTE 6

A417 Northbound Closed
Between
Spine Road Junction
And
Burford Road Interchange



CLOSED BETWEEN BURFORD ROAD INTERCHANGE AND SOUTH CERNEY JUNCTION

A419/A417 NORTHBOUND

Diversion Route
Symbol



Action Points

Step 1: Close A419/A417 Northbound carriageway at Cerney junction.
Step 2: Open trigger signs at South Cerney junction Exit Slip Road.
Reverse procedure at end of closure.

A417 Northbound Carriageway at South Cerney.

Northbound Exit Slip Road.

Standard Road Closure to TMC requirements

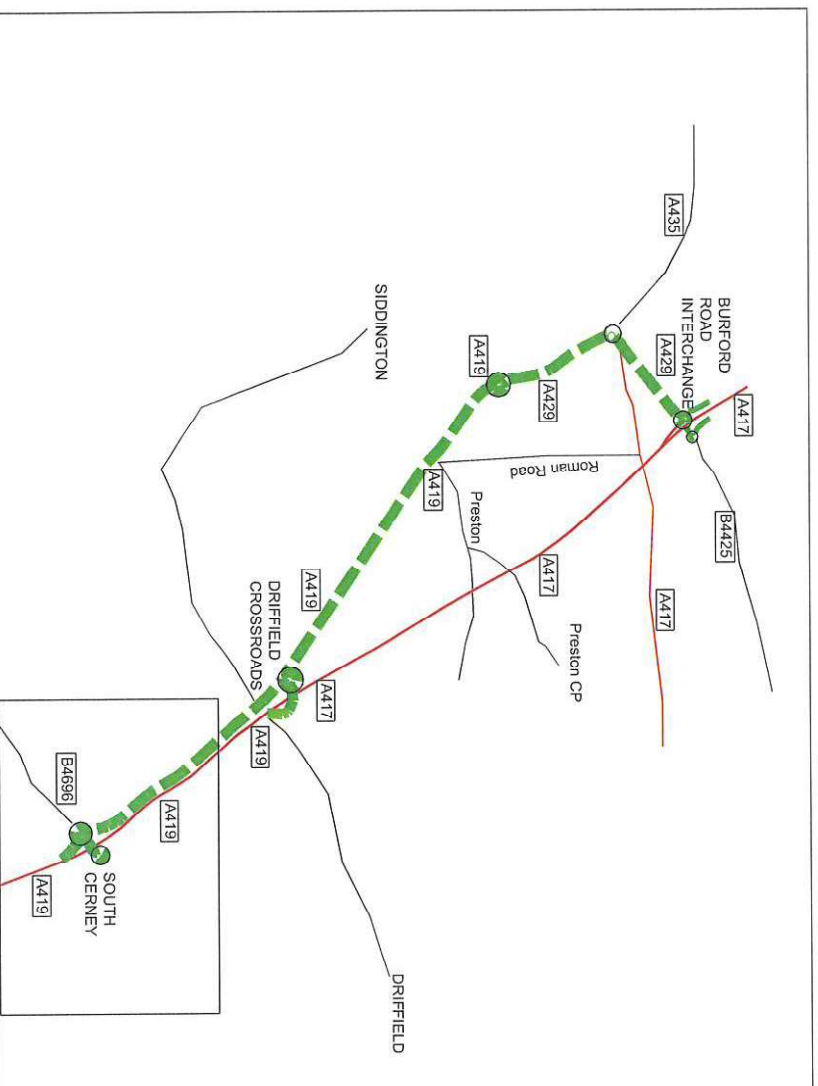

This route was agreed as the preferred option by the following parties during 2007:
Highways Agency, R.M.S., Gloucestershire Police and Gloucester County Council

HA HIGHWAYS
AGENCY

mouchel

Diversion Route 6 (Northbound)
Oct 2008

ROUTE 6

A417 Southbound Closed
Between
Burford Road Interchange
And
Spine Road Junction



CLOSED BETWEEN CIRENCESTER (BURFORD ROAD) AND SPINE ROAD JUNCTION.

Diversion Route
Symbol



Action Points

Step 1: Close A417/A419 Southbound carriageway at Burford Road Interchange.
Step 2: Open trigger signs at Burford Road Interchange Exit Slip Road.
Reverse procedure at end of closure.

A417 Southbound Main Carriageway at Burford Road Interchange Southbound Exit Slip Road.

Standard Road Closure to TMC requirements

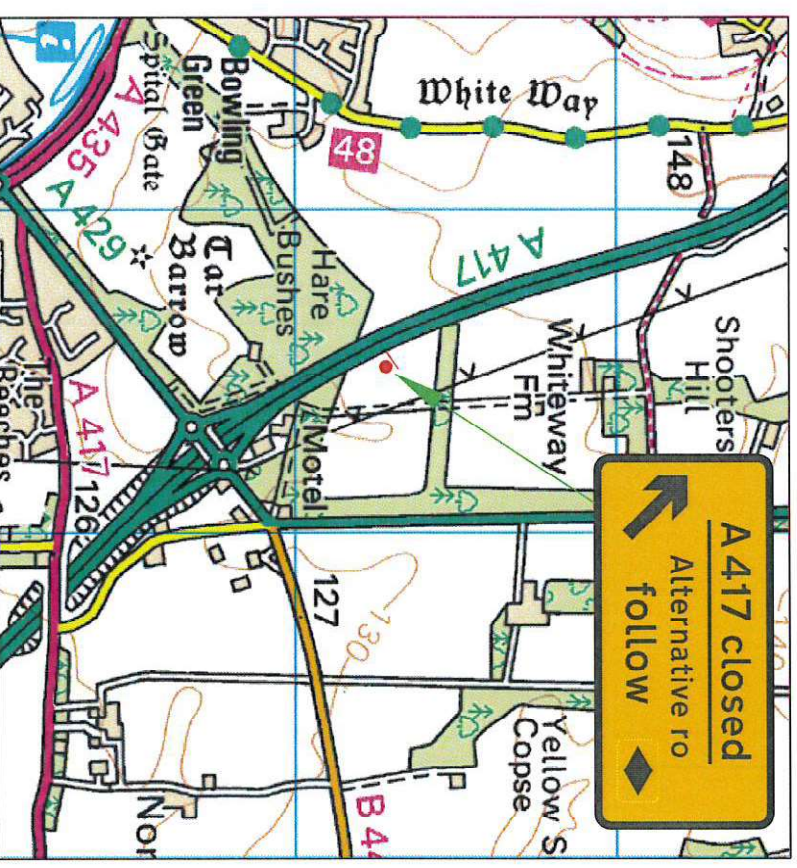
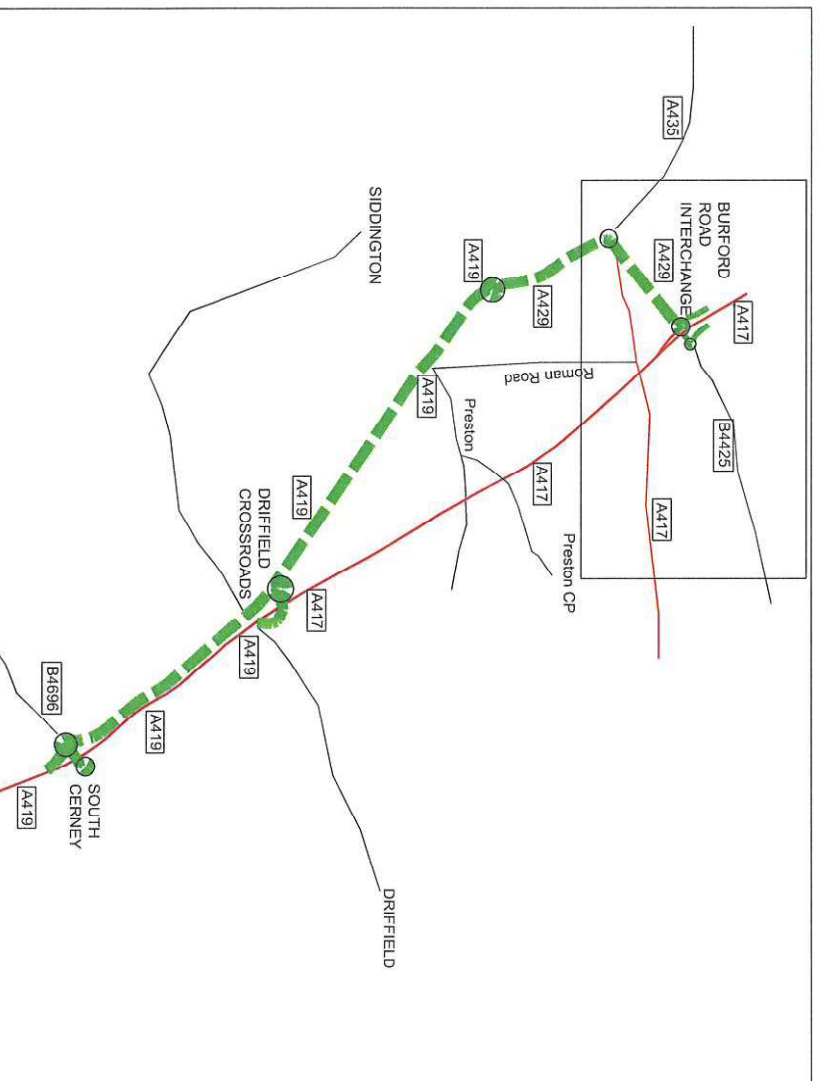

This route was agreed as the preferred option by the following parties during 2007:
Highways Agency, R.M.S. Gloucestershire Police and Gloucester County Council

HA HIGHWAYS
AGENCY

R mouchel

Diversion Route 6 (Southbound)
Oct 2008

A

ROUTE 10

A419 Northbound Closed
Between
M4 Junction 15 Roundabout
And
Commonhead Roundabout



Diversion Route 10 - Northbound

A419 Closure between M4 Junction 15 and Commonhead Junction

Key:

Diversion Route

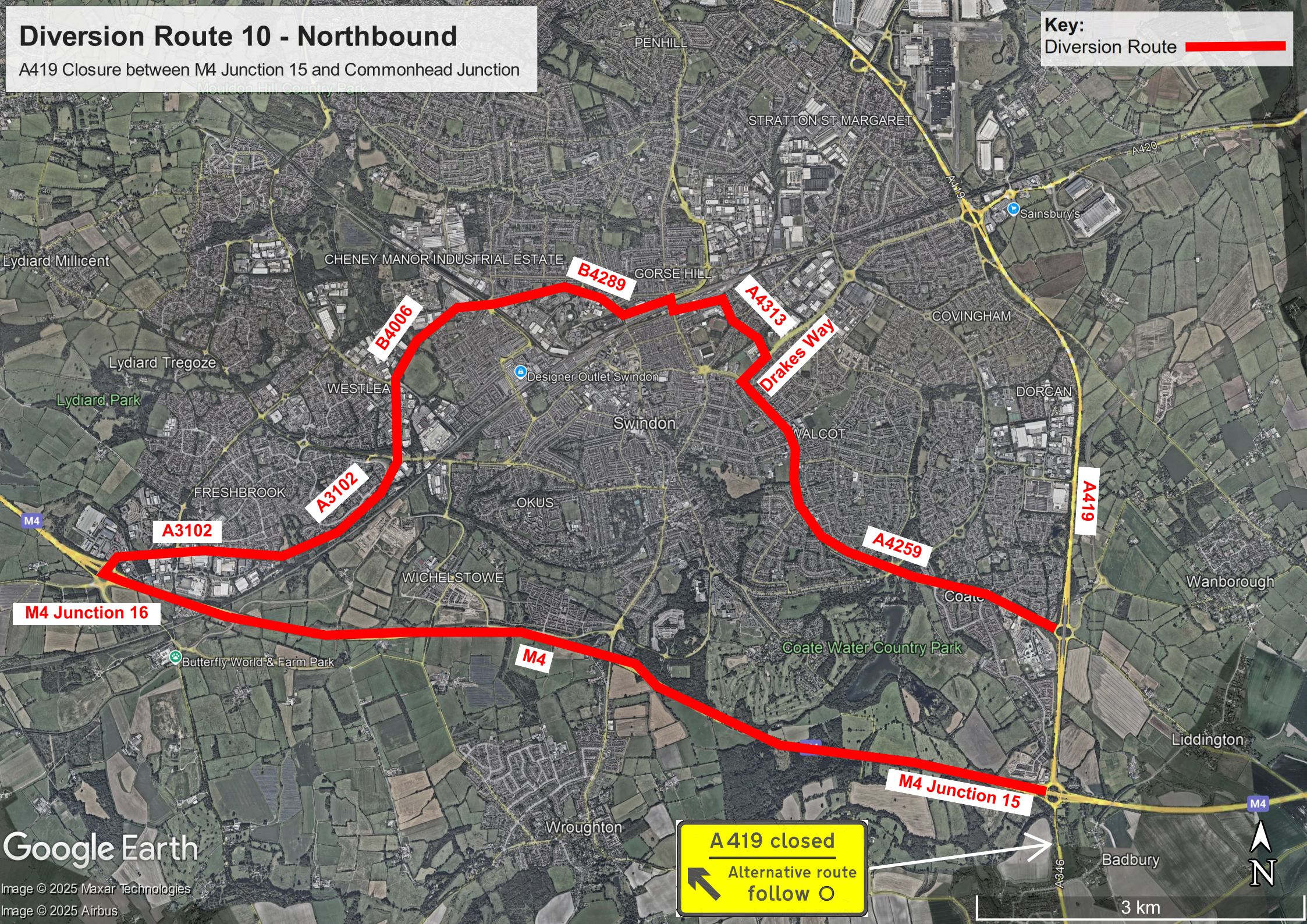

Google Earth

A 419 closed

Alternative route follow O

ROUTE 10

A419 Southbound Closed

At

Commonhead Junction

And

M4 Junction 15



Diversion Route 10 - Southbound

A419 Closure between Commonhead Junction and M4 Junction 15

Key:

Diversion Route 

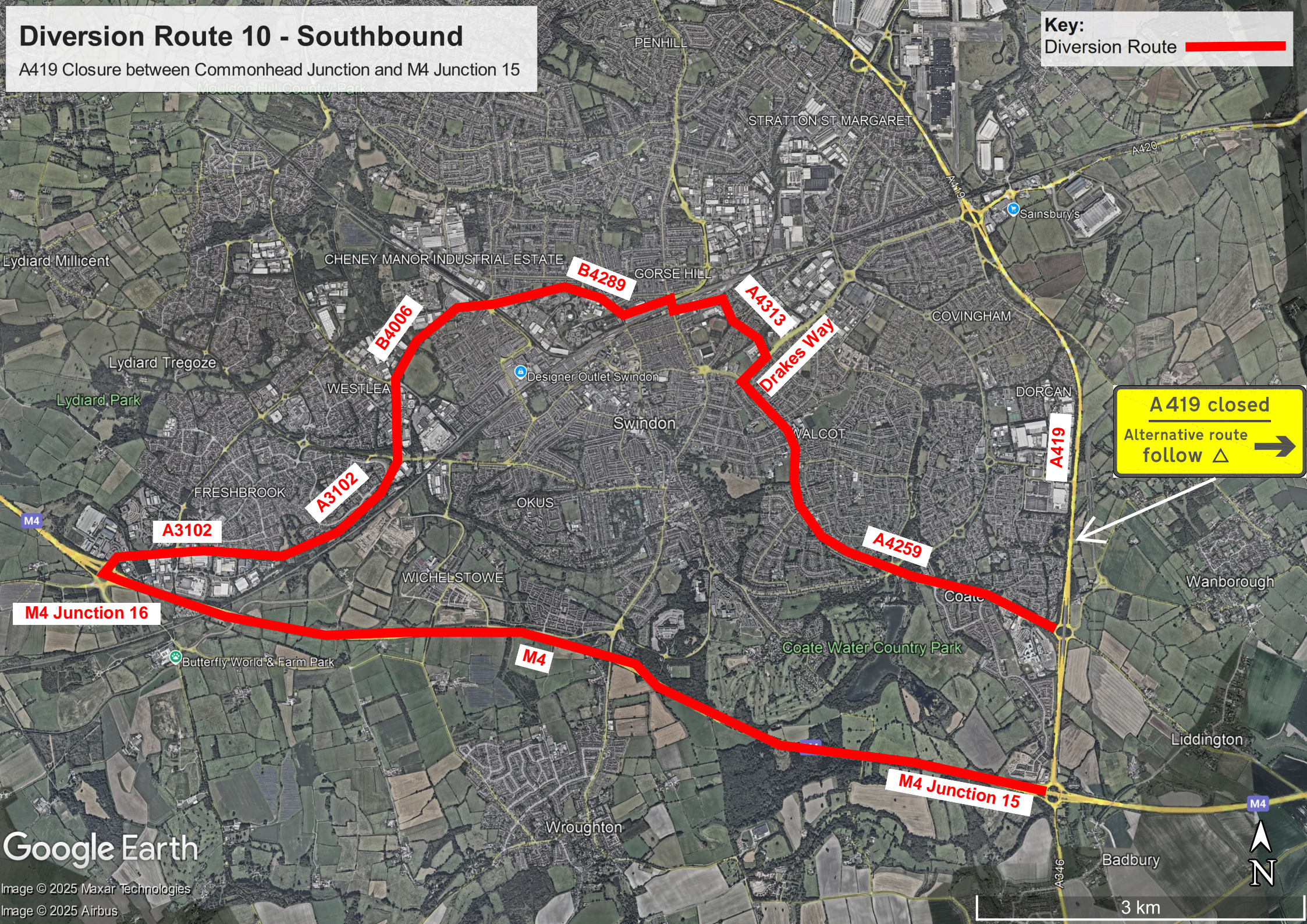

A 419 closed
Alternative route
follow Δ ➔

Google Earth

Image © 2025 Maxar Technologies
Image © 2025 Airbus

ROUTE 11

**A419 Northbound Closed
Between
Commonhead Roundabout
And
White Hart Roundabout**



A419 NORTHBOUND

CLOSED BETWEEN COMMONHEAD ROUNDABOUT AND WHITE HART ROUNDABOUT.



Diversion Route
Symbol

Action Points

- Step 1: Close A419 at Northbound carriageway at Commonhead roundabout junction with A4259.
- Step 2: Open trigger signs at Commonhead roundabout Northbound Exit Slip Road.
- Reverse procedure at end of closure.

A419 Northbound Carriageway at Commonhead Roundabout.

Standard Road Closure to TMC requirements

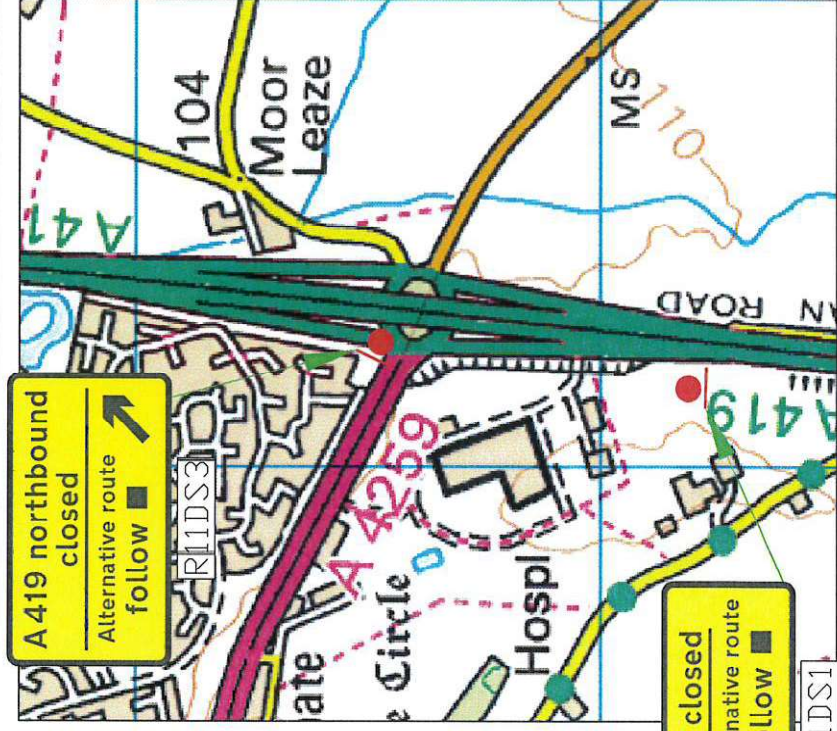
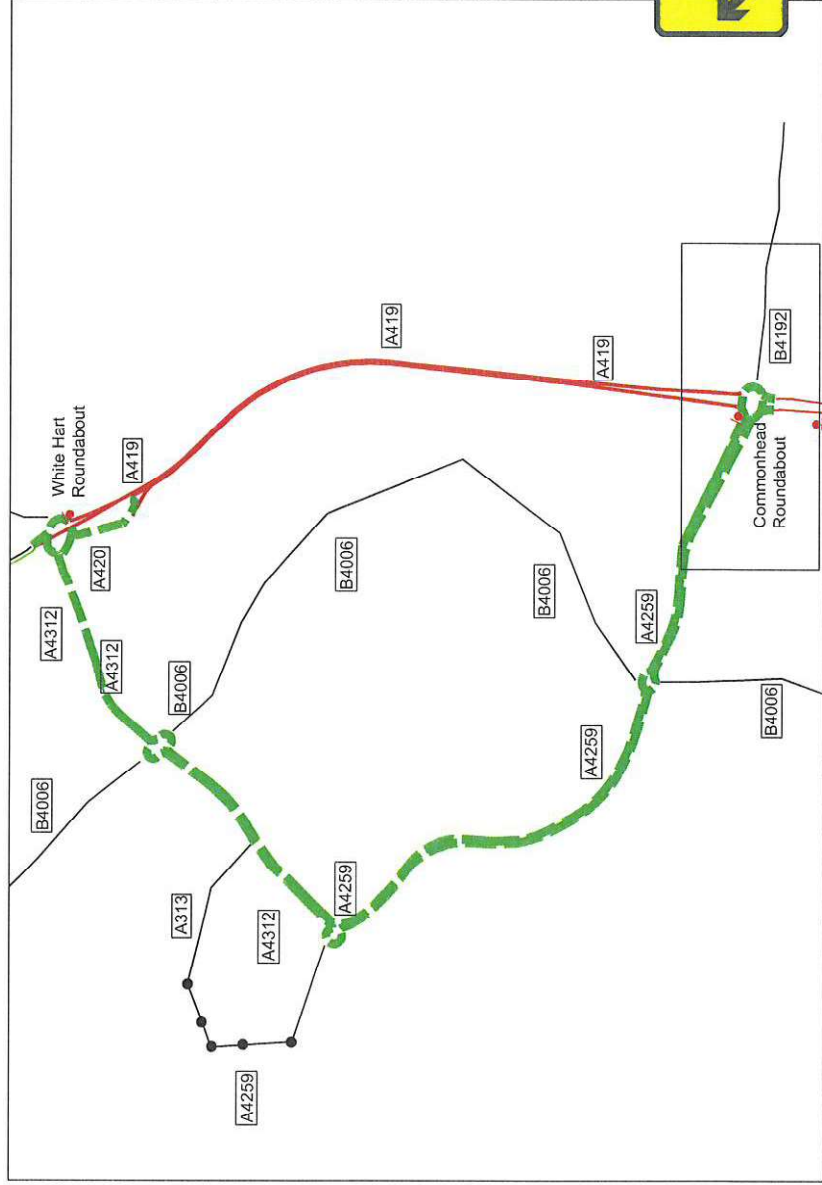

This route was agreed as the preferred option by the following parties during 2007:
Highways Agency, R.M.S. Gloucestershire Police and Gloucester County Council

HA HIGHWAYS
AGENCY

mouchel

Version
A
Diversion Route 11 (Northbound)
Date
Oct 2008

ROUTE 11

**A419 Southbound Closed
Between
White Hart Roundabout
And
Commonhead Roundabout**



A419 SOUTHBOUND CLOSED BETWEEN WHITE HART ROUNDABOUT AND COMMONHEAD ROUNDABOUT.



Diversion Route
Symbol

Action Points

- Step 1: Close A419 at Southbound carriageway at White Hart roundabout junction with A419/A4312.
- Step 2: Open trigger signs at White Hart roundabout Southbound Exit Slip Road.
- Reverse procedure at end of closure.

A419 Southbound Carriageway at White Hart Roundabout.

Standard Road Closure to TMC requirements

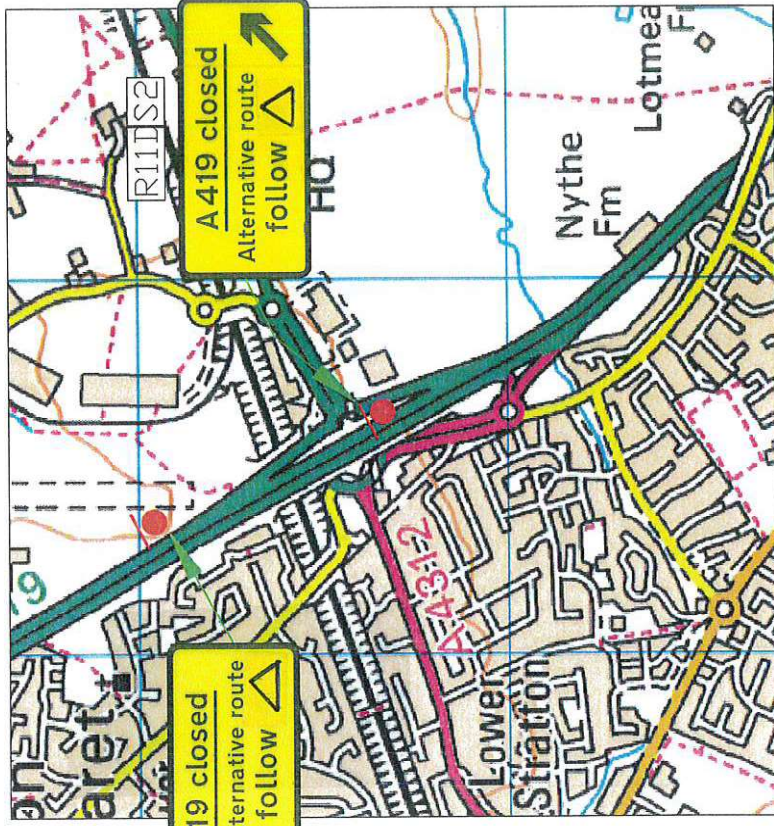
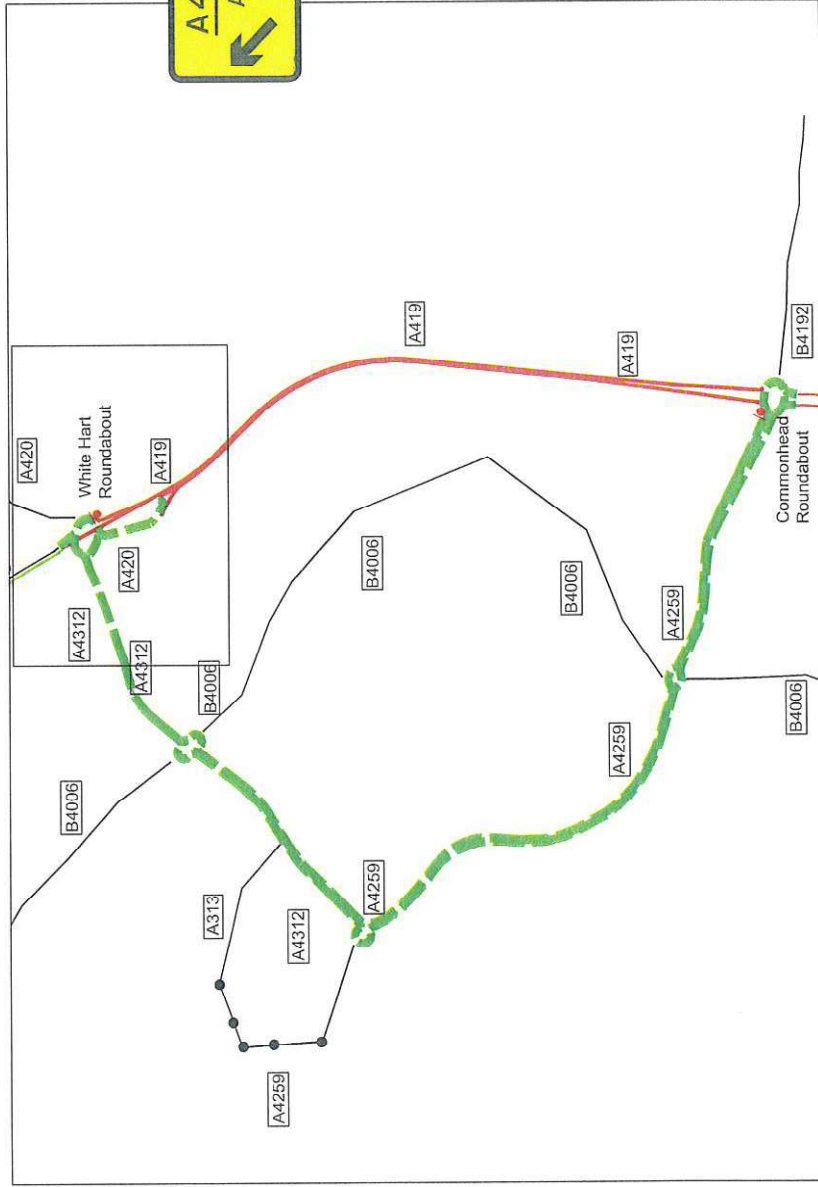

This route was agreed as the preferred option by the following parties during 2007:
Highways Agency, R.M.S. Gloucestershire Police and Gloucester County Council

HA HIGHWAYS
AGENCY

mouchel

Diversion Route 11 (Southbound)
A
Oct 2008

ROUTE 14

A419 Northbound Closed
Between
Turnpike Junction
And
Spine Road Junction



A419 NORTHBOUND

CLOSED BETWEEN TURNPIKE JUNCTION AND SPINE

ROAD JUNCTION

Diversion Route
Symbol



Action Points

- Step 1: Close A419 Northbound carriageway at Turnpike Junction with A4311.
- Step 2: Open trigger signs at Turnpike Junction Northbound Exit Slip Road.
- Reverse procedure at end of closure.

Standard Road Closure to TMC requirements

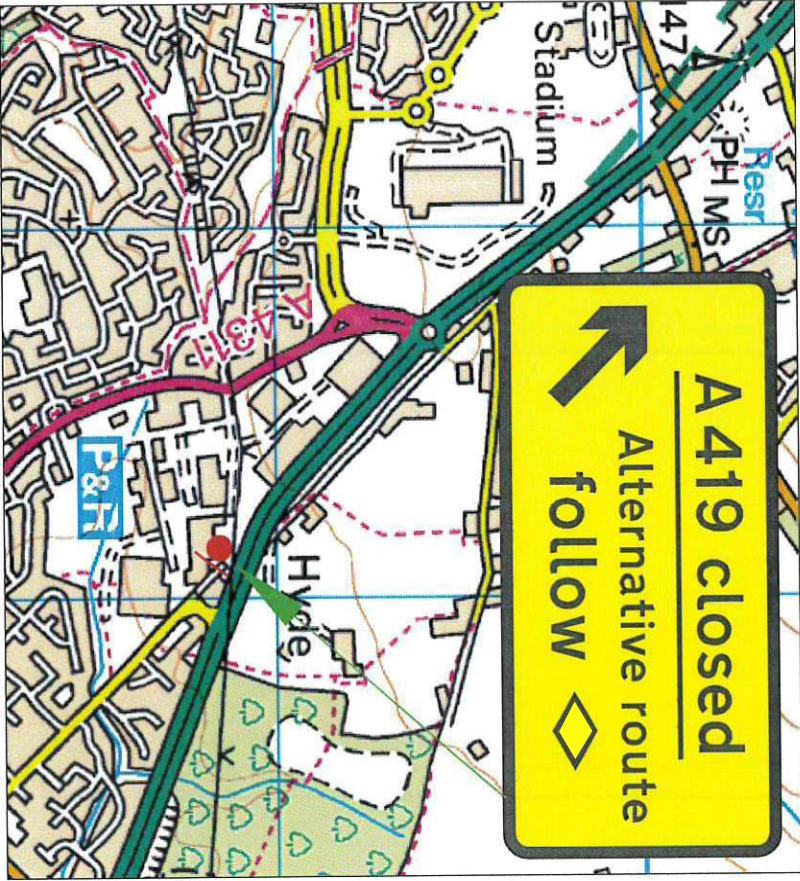
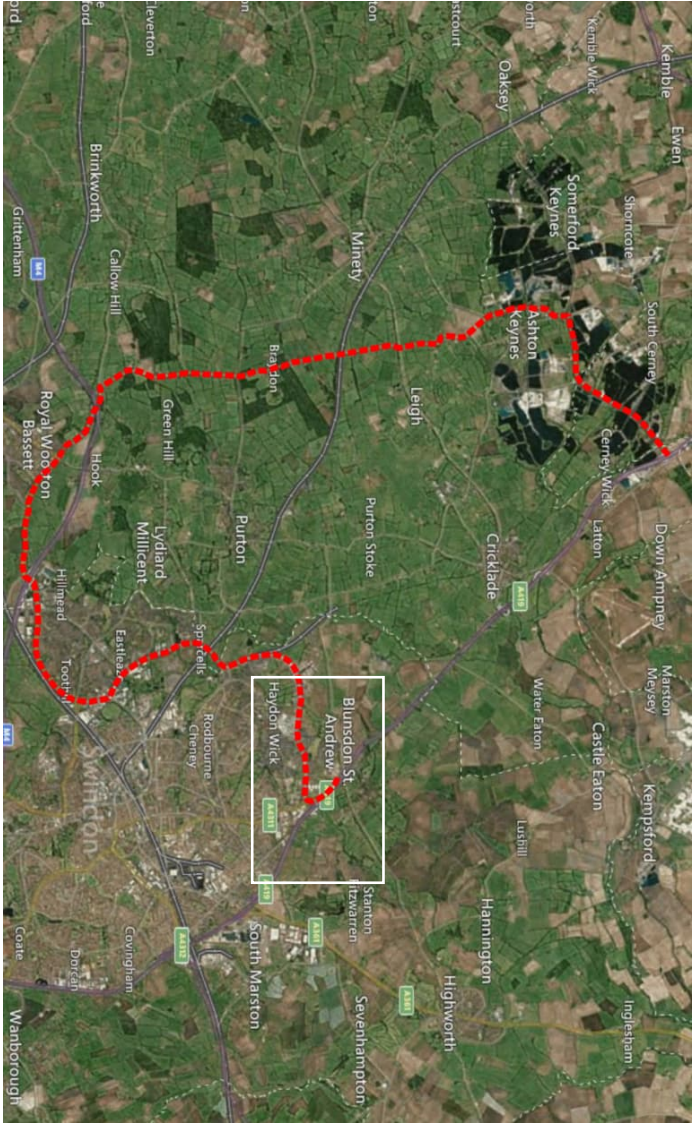

This route was agreed as the preferred option by the following parties during 2007:
Highways Agency, R.M.S. Gloucestershire Police and Gloucester County Council



Diversion Route 14 (Northbound)
Aug 2024